



**IKS
LIVE**

**Goldmember Mobile
Technical Specifications:**

ALWAYS THE BEST SEAT IN THE HOUSE

www.ikslive.ca



Goldmember Mobile Technical Specifications:

Production Switcher:

Ross Carbonite Ultra UHD 1M/E
24 inputs
9 aux bus outputs
4 Keyers per M/E
4 mini M/E w/ 2 DVE
4 channels of internal media store w/ media wipe transitions
4 internally generated Multiview outputs
Custom control and macro programming
Touchscreen dashboard connection at TD position
Frame sync and up/down conversion and Proc-Amp on all inputs and outputs

Switchgear & Routing:

Ross NK-3G72 w/ NK-IPS and RCP-NK1
Remote I/O rack:
BMD 40x40 4k router
Behringer S16 AES-50 remote audio i/o
4x HD fiber bi-directional converters
Ethernet hub and Visca/rs-422/rs-232 data connections for RTD or Camera control
200' cabling for 12 channels of video and all audio/fiber/data connections

Playback/record:

Newtek 3Play 4800
8 in/ 2 out simultaneous recording/playback
Multi-Definition capability w/ frame sync, up/down and proc amp on all inputs
Blackmagic Hyperdeck
Dual 500gb HDD
Multiple recording formats including ProRes HQ 10 bit 4:2:2
Ross Blackstorm 2ch Clip Server
2 channels of multi definition playout with switcher integration
Can be used for animated transitions as well as clip playout
Ability to add additional recording devices including second replay machine as required.

Graphics:

Motion Rocket Pro
Two independent key/fill outputs
Dual RTD data integrations
Dual XML Stat integration
Any format input/playout configuration
Up to 3 additional output surfaces for LED screen integration

sales@iksmmedia.com
306.359.1547

www.ikslive.ca



Goldmember Mobile Technical Specifications:

V-mix 4k:

Single channel of Key-Fill output from v-mix (useful for GT title and web capture)
Dual V-Call remote call in
Touchscreen Telestrator

Cameras:

5 x Hitachi Z-HD5000 2/3" CCD Cameras with HDR capability and full SMPTE chains
3 x Hard camera configurations with 20x Canon lenses w/ 2x extenders and HD Color VF
2 x ENG configurations with Canon 11x wide angle lenses w/ 2x extenders
3000' of SMPTE cable available
Sachtler Video 18SB style tripods
2 x Sony BRC-900 Remote cameras
 -1/2" Sony CMOS sensors w/ full color matrix
2 x Bolin 7 Series 4k PTZ camera w/ full color matrix
Marshall POV lipstick camera
CV-HD Pro-300 wireless 1000' wireless transmitter kit w/ paddle antenna
Additional ENG style Sony PMW series cameras available upon request
12' Glidecam 2000 mini jib also available upon request

Streaming/Encoding:

2 x AJA Helo RTMP streaming encoder/recorder
Dejero GoBox & 2 channel Live+ server
Vmix 4k encoder w/ SRT
More encoders available upon request

Audio:

Midas M32 32 channel Digital mixing console
Dante dual network connection included
S16 remote I/O with 16 in & 8 out
8 channel sennheiser wireless mic kit
8 LAV mic belt packs
1 Sennheiser e935 handheld wireless mic (with mic flag)
Dual distribution true diversity antenna system with paddle antennas
2 x AB-120 Announcer Boxes with IFB and talkback (4 available upon request)
2 x Sennheiser HMD 25-II headsets
2 x Audio Technica AT-2050 omnidirectional mic
1 x EV RE50 wired handheld mic (with mic flag)
2 x AKG C-1000 hypercardioid condenser mics
2 x AT Pro-37r cardioid condenser mics (mini shotgun mics)
1 x 4 channel AJA SDI Audio embedder
1 x Ross MUX-8258 16 channel AES audio embedder
2 x UltraMatch 2496 AD/DA audio converters
2 x ART Z-Direct passive DI boxes

sales@iksmedia.com
306.359.1547

www.ikslive.ca



Goldmember Mobile Technical Specifications:

Intercom:

RTS Adam Matrix Intercom System
96x96 matrix
4 channel 4wire to 2wire converter
RVON 16 RTS Voice-over-Network card
RTS IFB8 tactile IFB controller (located in audio booth)
RTS TIF-2000A Digital Hybrid phone line interface
RadioComm BTR-800 2-channel wireless intercom (B4 Band)
4 x TR-800 wireless beltacks
(additional wireless basestation and beltacks available upon request)

Video Processing:

Carbonite Ultra has Frame Sync, Up/Down and Proc Amp on all inputs and outputs
2 x AJA UDC up/down/cross converter
2 x EzSHV up/down/cross converters w/ LED monitor
2 x BMD SDI to Analog converters
6 x BMD HDIM to SDI micro converters
6 x BMD SDI to HDMI micro converters (4 attached to monitor kit)
6 x BMD HDMI to SDI inputs to OG3 for internal UI routing
Multiple 1x2 and 1x4 HDMI splitters
Blackbird SDI to VGA converter
8 x BMD SDI to Fiber bidirectional converters
Decimator D-MON 4s 4 way multiview
Decimator D-MON 9s 9 way Multiview (for shader station)
Leader LV-7700 Multi def Rasterizer (for shader station)
RCP-NK1 (for shader station)
4 x remote monitor kit (for talent view or stand up locations)
4k booth monitor

sales@iksmmedia.com
306.359.1547

www.ikslive.ca



Goldmember Mobile Technical Specifications:

Additional Information:

HDMI/Network/Audio inputs located in production area for additional outboard equipment integration
Two sony VISCA controllers and camera control routing so cameras can be controlled by multiple operators or assigned to different surfaces
24 BNC I/O patchbay in truck
Selection of 300', 200' & 100' multichannel audio mult
Selection of 100-300' SDI multichannel cables
Approx 2000' of belden 1694a SDI cabling in various lengths from 6'-300'

Park & Power Requirement:

Unit Parking:

Minimum parking space required: 14'W x 36'L

Preferred parking space allotted: 20'W x 40'L

Power Requirements:

220-240VAC, Single phase 50 Amp connection

Power connection can any one of the following:

Bare wire Bus termination

Cam-Loc connections

125/250VAC single phase 50a Twist lock (preferred connection)

220-240VAC single phase 50a Range plug (also preferred)

Truck carries 150' of power feed cabling

sales@iksmedia.com
306.359.1547

www.ikslive.ca

**IKS
LIVE**

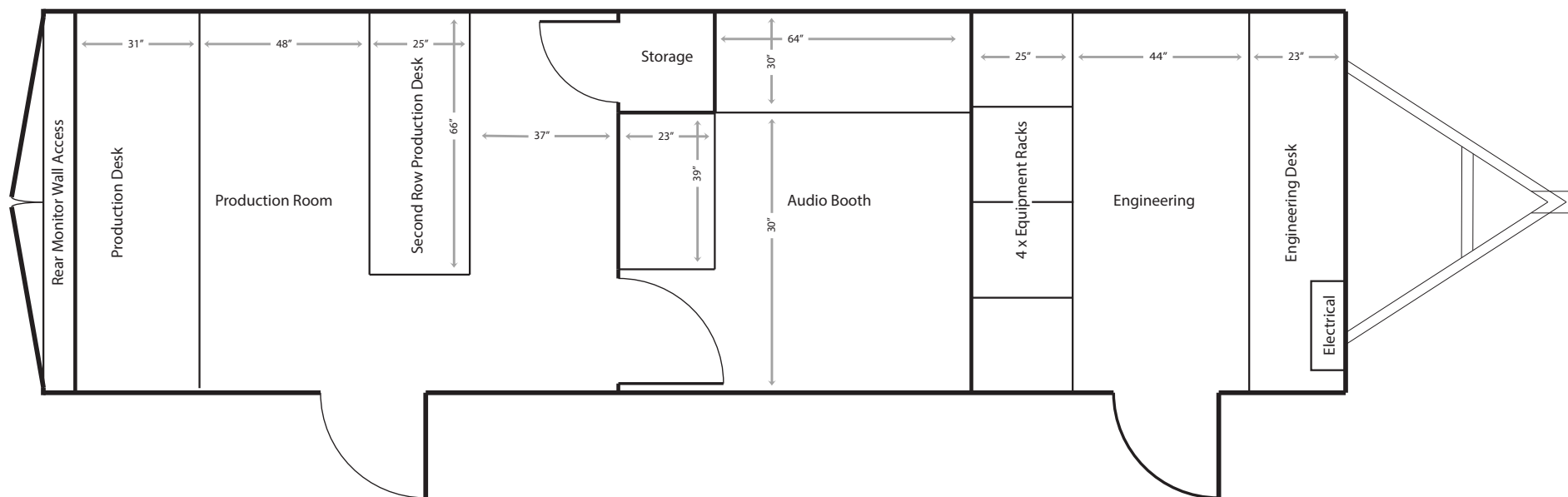

sales@iksmedia.com
306.359.1547

www.ikslive.ca